

Tolerance Class	Basic Size Range (mm)							
	0.5~3	>3~6	>6~30	>30~120	>120~400	>400~1000	>1000~2000	>2000~4000
Very Coarse	-	±0.5	±1	±1.5	±2.5	±4	±6	±8

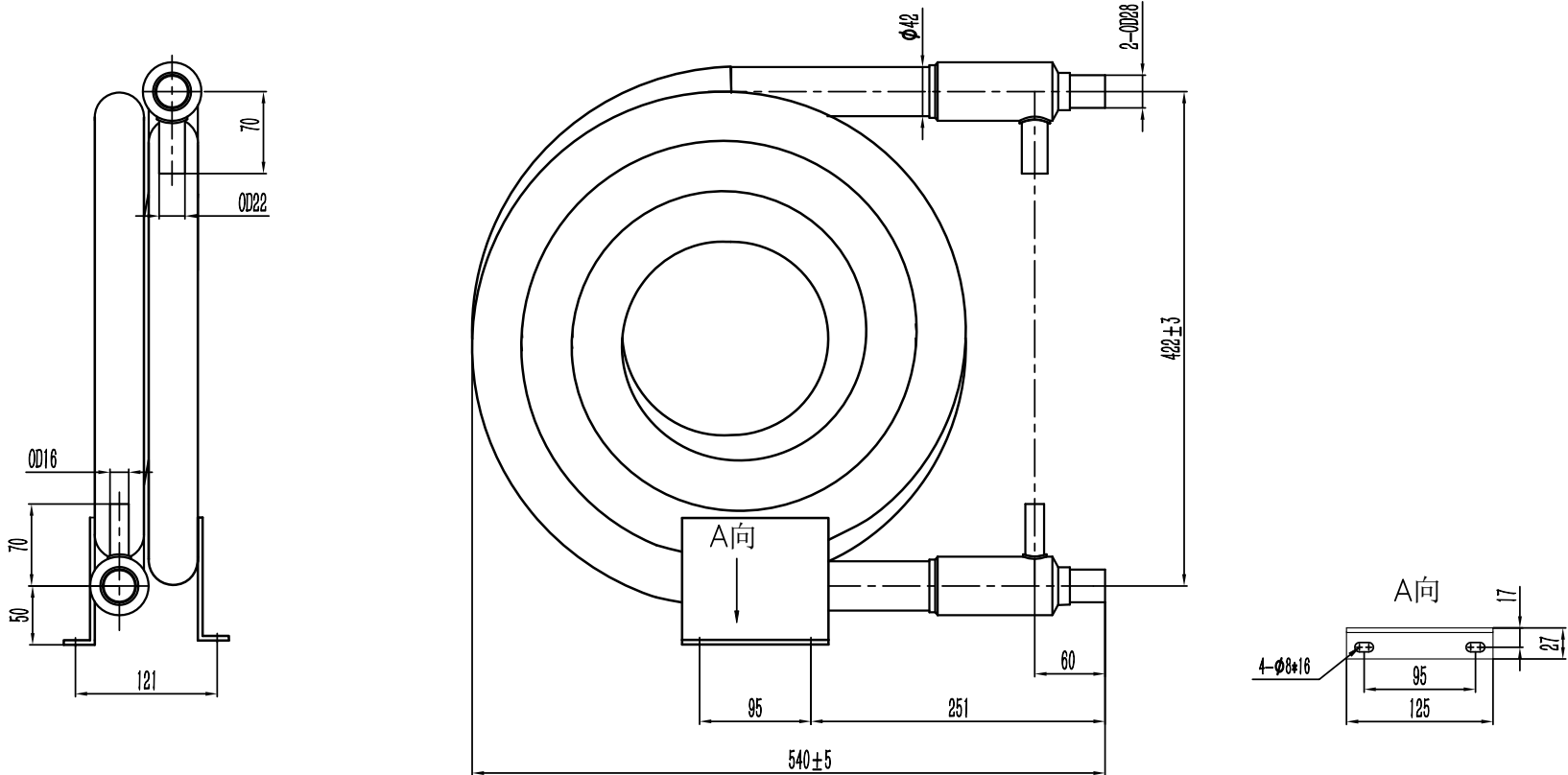

Technical Specifications

1. Inner tube and outer tube should be cleaned so that ensure the surface of the inner and outer tube to be clean without impurities,
2. All welded place should be well welded. Any defect on small holes and leaks is unacceptable,
3. Heat exchanger is black painted except 25±5mm cylinder from connections end,
4. Each end connection should be sealed by a plastic cap or welding,
5. Fill 0.05-0.12Mpa nitrogen gas at refrigerant side, the pressure is maintained,
6. Any non-indicated dimensions and tolerances are subject to GB/T1804 V degree,
7. Other non-indicated requirements are subject to 《GB/T 25862-2010》.

Design Data Sheet								Coaxial Heat Exchanger			ΤΕΨΕ ΨΥΚΤΙΚΑ ΚΩΔΙΚΟΣ ΕΙΔΟΥΣ: 04-290-5860
Item	Tube Side	Shell Side						Inner tube: Copper			
Medium	Water	R410A/R22						Outer tube: Steel			
Design Temp/°C	65	100	Mark	No.	Modify Documents No.	Sign	Date	Drawing Mark	Weight	Scale	SS-0620GT-W
Design Pressure/MPa	1.5	4.2	Design			Standard					
Insulation	\		Check			Authorize				1:6	CSSE6203100
Customer Drawing No.	\		Approve					Total Page	Page		
Customer Item No.	\		Process			Date					